

Katharine Kepple

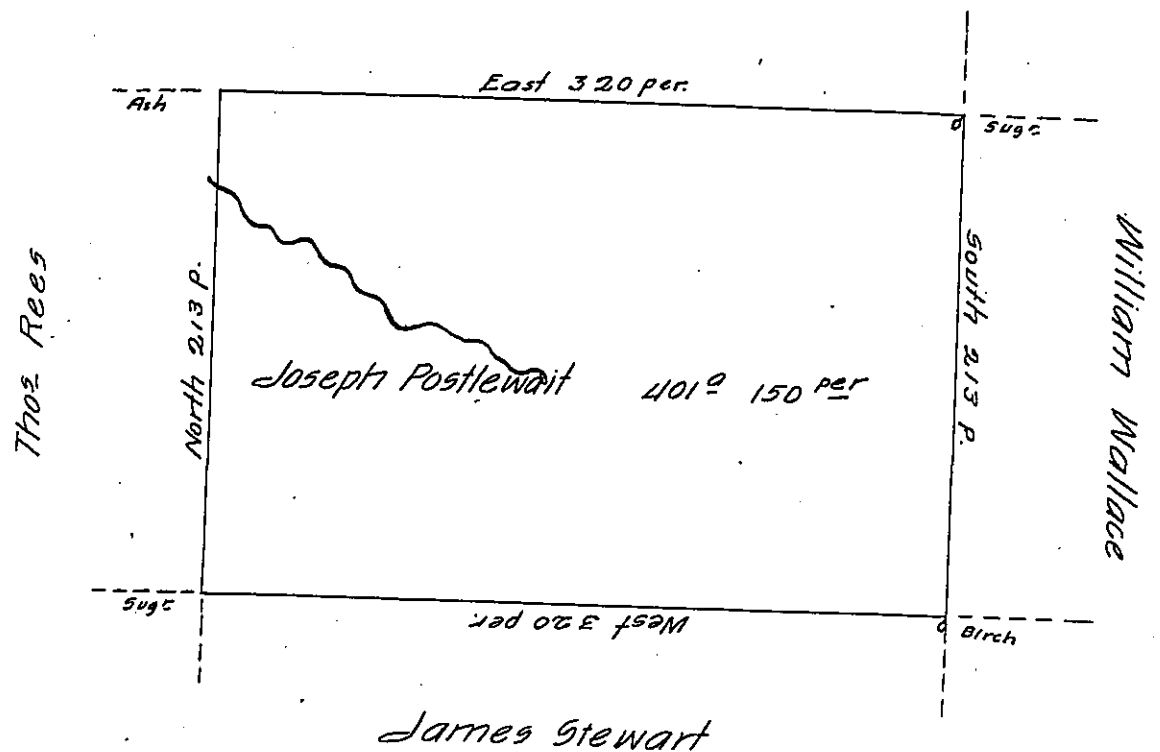

Situate on the West Side of French Creek in Allegheny County
 Containing 401 1/2 150 perches and allowance of Six per Cent for Roads &c.
 Surveyed the 2^d Day of ^{June} ~~May~~ 1795. In pursuance of his Improvement dated
 the 1st Day of June 1795.

W^m Power D^y 55.

To Dan^l Brodhead Esquire }
 Surveyor General }

IN TESTIMONY that the above is a copy of the original remaining on file in
 the Department of Internal Affairs of Pennsylvania, made
 conformably to an Act of Assembly approved the 16th day of
 February, 1833, I have hereunto set my Hand and caused
 the Seal of said Department to be affixed at Harrisburg,
 this fifth day of August 1904

James D. Brown
 Secretary of Internal Affairs.